

PLOT LOCATOR

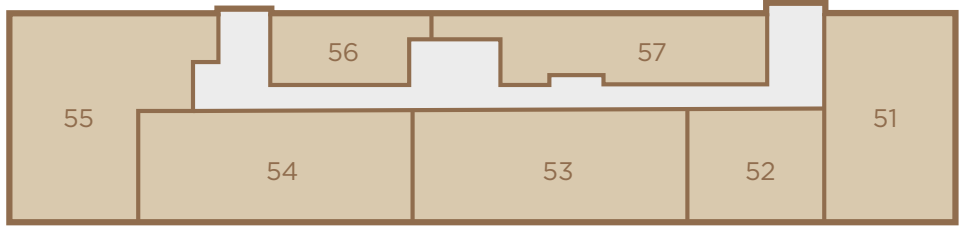

Fifth Floor

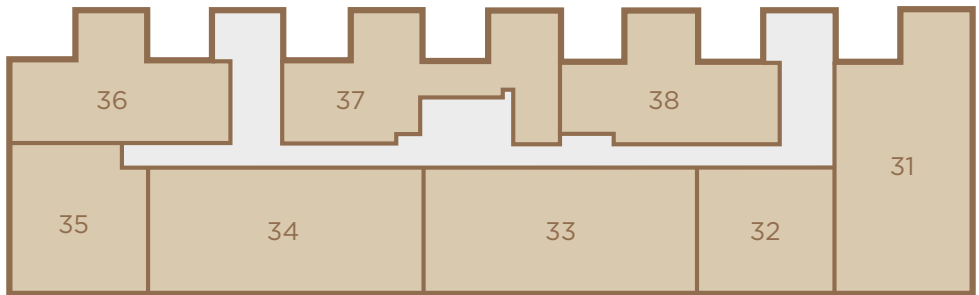

Third Floor

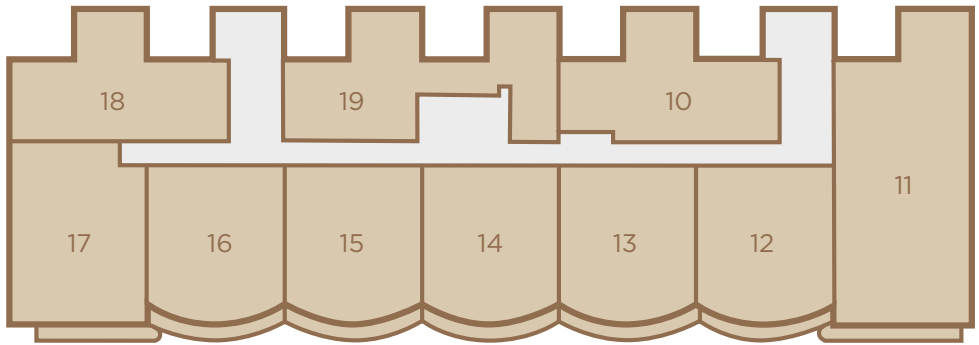

First Floor

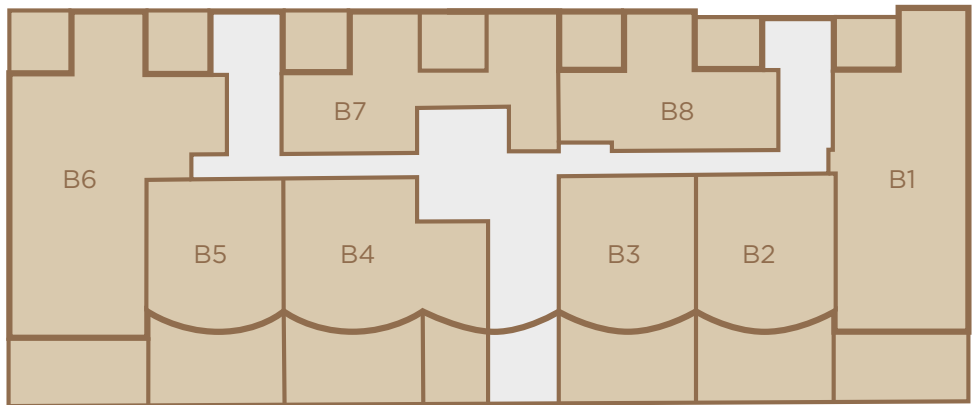

Lower Ground Floor

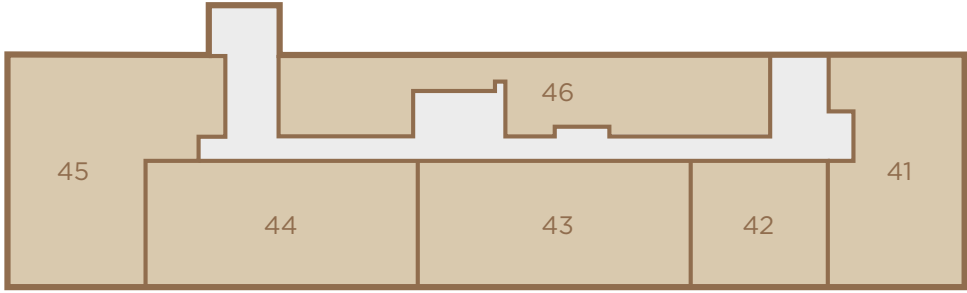

Fourth Floor

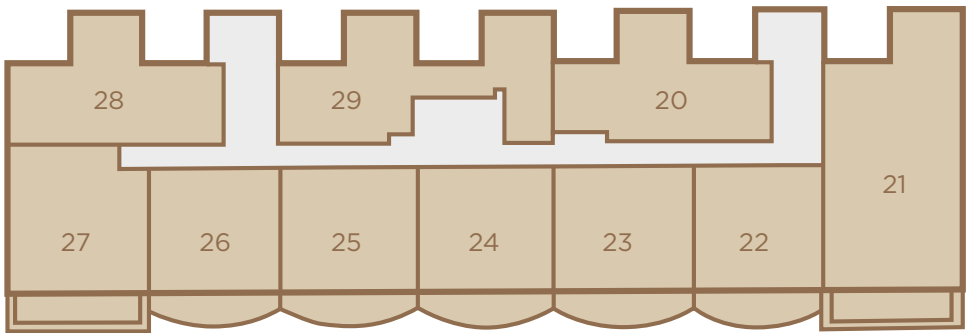

Second Floor

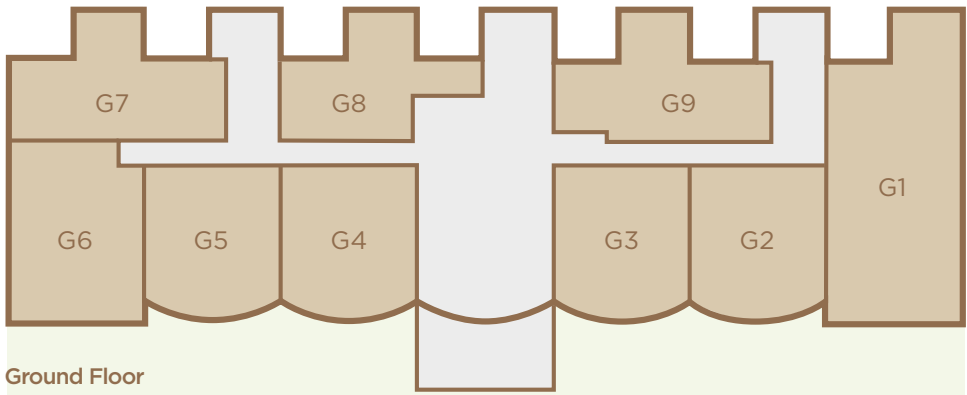

Ground Floor



ACCOMMODATION SCHEDULE



Arranged over seven floors, Garden House boasts a selection of one, two & three bedroom apartments. With meticulous attention to detail, every single aspect has been most carefully and thoughtfully considered.

| APARTMENT | LEVEL | BEDS | TOTAL AREA SQ FT | TOTAL AREA SQ M | PAGE |
|-----------|--------------|------|------------------|-----------------|------|
| B1 | Lower Ground | 2 | 768 | 71.35 | 43 |
| B2 | Lower Ground | 1 | 391 | 36.33 | 43 |
| B3 | Lower Ground | 1 | 389 | 36.14 | 43 |
| B4 | Lower Ground | 2 | 537 | 49.89 | 44 |
| B5 | Lower Ground | 1 | 391 | 36.33 | 43 |
| B6 | Lower Ground | 3 | 928 | 86.21 | 44 |
| B7 | Lower Ground | 1 | 477 | 44.31 | 45 |
| B8 | Lower Ground | 1 | 402 | 37.25 | 45 |
| G1 | Ground | 2 | 782 | 72.65 | 46 |
| G2 | Ground | 1 | 390 | 36.23 | 46 |
| G3 | Ground | 1 | 390 | 36.23 | 46 |
| G4 | Ground | 1 | 390 | 36.23 | 46 |
| G5 | Ground | 1 | 390 | 36.23 | 46 |
| G6 | Ground | 1 | 466 | 43.29 | 47 |
| G7 | Ground | 1 | 413 | 38.37 | 47 |
| G8 | Ground | 1 | 324 | 30.10 | 48 |
| G9 | Ground | 1 | 405 | 37.63 | 47 |
| 10 | First | 1 | 404 | 37.53 | 48 |
| 11 | First | 2 | 781 | 72.56 | 49 |
| 12 | First | 1 | 390 | 36.23 | 49 |
| 13 | First | 1 | 390 | 36.23 | 49 |
| 14 | First | 1 | 390 | 36.23 | 49 |
| 15 | First | 1 | 390 | 36.23 | 49 |
| 16 | First | 1 | 390 | 36.23 | 49 |
| 17 | First | 1 | 464 | 43.11 | 50 |
| 18 | First | 1 | 414 | 38.46 | 48 |
| 19 | First | 1 | 478 | 44.41 | 50 |
| 20 | Second | 1 | 408 | 37.90 | 51 |
| 21 | Second | 2 | 688 | 63.92 | 51 |
| 22 | Second | 1 | 330 | 30.66 | 52 |
| 23 | Second | 1 | 330 | 30.66 | 52 |
| 24 | Second | 1 | 330 | 30.66 | 52 |
| 25 | Second | 1 | 326 | 30.29 | 52 |
| 26 | Second | 1 | 326 | 30.29 | 52 |
| 27 | Second | 1 | 371 | 34.47 | 52 |
| 28 | Second | 1 | 410 | 38.09 | 51 |
| 29 | Second | 1 | 477 | 44.31 | 53 |
| 31 | Third | 2 | 700 | 65.03 | 53 |
| 32 | Third | 1 | 326 | 30.29 | 54 |
| 33 | Third | 2 | 690 | 64.10 | 54 |
| 34 | Third | 2 | 689 | 64.01 | 54 |
| 35 | Third | 1 | 376 | 34.93 | 55 |
| 36 | Third | 1 | 411 | 38.18 | 55 |
| 37 | Third | 1 | 474 | 44.04 | 56 |
| 38 | Third | 1 | 406 | 37.72 | 55 |
| 41 | Fourth | 2 | 604 | 56.11 | 56 |
| 42 | Fourth | 1 | 344 | 31.96 | 57 |
| 43 | Fourth | 2 | 698 | 64.85 | 57 |
| 44 | Fourth | 2 | 702 | 65.22 | 57 |
| 45 | Fourth | 2 | 783 | 72.74 | 59 |
| 46 | Fourth | 2 | 697 | 64.75 | 58 |
| 51 | Fifth | 1 | 545 | 50.63 | 59 |
| 52 | Fifth | 1 | 329 | 30.57 | 60 |
| 53 | Fifth | 2 | 659 | 61.22 | 60 |
| 54 | Fifth | 2 | 662 | 61.50 | 60 |
| 55 | Fifth | 2 | 685 | 63.64 | 61 |
| 56 | Fifth | 1 | 200 | 18.58 | 61 |
| 57 | Fifth | 1 | 410 | 38.09 | 62 |

APARTMENT B1 2 BEDROOM APARTMENT LOWER GROUND FLOOR

| | | |
|-----------------------|---------------|--------------|
| Reception | 18'6" x 13'6" | 5.64 x 4.11m |
| Kitchen | 9'3" x 7'9" | 2.82 x 2.36m |
| Master Bedroom | 13' 6" x 9'3" | 4.11 x 2.82m |
| Bedroom 2 | 10'9" x 9'0" | 3.28 x 2.74m |
| Total | 768 sq ft | 71.35 sq m |

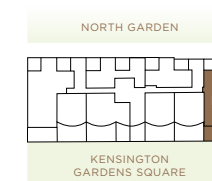

APARTMENTS B2, B3 & B5 1 BEDROOM APARTMENT LOWER GROUND FLOOR

| | | |
|--------------------------------------|--------------|--------------|
| Reception/Kitchen | 21'9" x 8'9" | 6.63 x 2.67m |
| Bedroom | 10'6" x 9'0" | 3.20 x 2.74m |
| Total | 391 sq ft | 36.33 sq m |
| <i>B3 dimensions differ as below</i> | | |
| Reception/Kitchen | 21'6" x 9'0" | 6.55 x 2.74m |
| Bedroom | 10'3" x 8'9" | 3.12 x 2.67m |
| Total | 389 sq ft | 36.14 sq m |

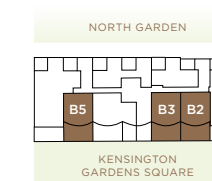

Floor plans shown are for approximate measurements only. Floor plans not to scale. Exact layout and sizes may vary. Furniture sizes and layout are for indicative purposes only.



APARTMENT B4
2 BEDROOM APARTMENT
LOWER GROUND FLOOR

| | | |
|--------------------------|-------------|--------------|
| Reception/Kitchen | 22' x 8'9" | 6.71 x 2.67m |
| Master Bedroom | 9'0" x 9'0" | 2.74 x 2.74m |
| Total | 537 sq ft | 49.89 sq m |

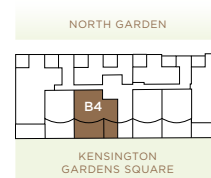

APARTMENT B6
3 BEDROOM APARTMENT
LOWER GROUND FLOOR

| | | |
|--------------------------|---------------|--------------|
| Reception/Kitchen | 19'0" x 18'6" | 5.79 x 5.64m |
| Master Bedroom | 12'6" x 10'9" | 3.81 x 3.28m |
| Bedroom 2 | 15'3" x 9'3" | 4.65 x 2.82m |
| Bedroom 3 | 10'9" x 10'3" | 3.28 x 3.12m |
| Total | 928 sq ft | 86.21 sq m |

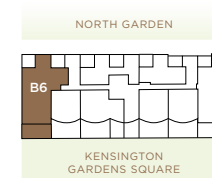

APARTMENT B7
1 BEDROOM APARTMENT
LOWER GROUND FLOOR

| | | |
|------------------|---------------|--------------|
| Reception | 11'3" x 10'9" | 3.43 x 3.28m |
| Kitchen | 13'0" x 9'3" | 3.96 x 2.82m |
| Bedroom | 12'0" x 9'6" | 3.66 x 2.90m |
| Total | 477 sq ft | 44.31 sq m |

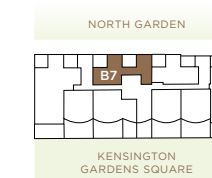

APARTMENT B8
1 BEDROOM APARTMENT
LOWER GROUND FLOOR

| | | |
|------------------|---------------|--------------|
| Reception | 11'9" x 10'9" | 3.58 x 3.28m |
| Kitchen | 9'0" x 8'0" | 2.74 x 2.44m |
| Bedroom | 10'9" x 10'3" | 3.28 x 3.12m |
| Total | 402 sq ft | 37.35 sq m |

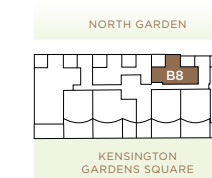

Floor plans shown are for approximate measurements only. Floor plans not to scale. Exact layout and sizes may vary. Furniture sizes and layout are for indicative purposes only.



APARTMENT G1
2 BEDROOM APARTMENT
GROUND FLOOR

| | | |
|-----------------------|---------------|--------------|
| Reception | 18'6" x 15'9" | 5.64 x 4.80m |
| Kitchen | 9'3" x 6'0" | 2.82 x 1.83m |
| Master Bedroom | 13'6" x 9'9" | 4.11 x 2.97m |
| Bedroom 2 | 11'9" x 9'0" | 3.58 x 2.74m |
| Total | 782 sq ft | 72.65 sq m |

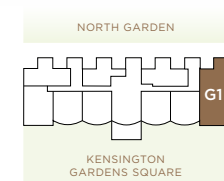

APARTMENTS G2, G3, G4 & G5
1 BEDROOM APARTMENT
GROUND FLOOR

| | | |
|--------------------------|--------------|--------------|
| Reception/Kitchen | 21'9" x 9'0" | 6.63 x 2.74m |
| Bedroom | 10'9" x 9'0" | 3.28 x 2.74m |
| Total | 390 sq ft | 36.23 sq m |

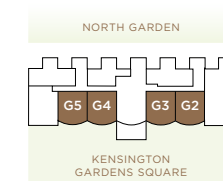

APARTMENT G6
1 BEDROOM APARTMENT
GROUND FLOOR

| | | |
|--------------------------|---------------|--------------|
| Reception/Kitchen | 18'6" x 14'0" | 5.64 x 4.27m |
| Bedroom | 11'6" x 8'9" | 3.51 x 2.67m |
| Total | 466 sq ft | 43.29 sq m |

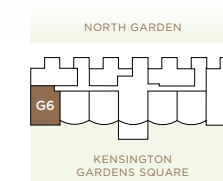

APARTMENTS G7 & G9
1 BEDROOM APARTMENT
GROUND FLOOR

| | | |
|------------------|---------------|--------------|
| Reception | 11'9" x 11'9" | 3.58 x 3.58m |
| Kitchen | 9'3" x 6'9" | 2.82 x 2.06m |
| Bedroom | 11'9" x 10'3" | 3.58 x 3.12m |
| Total | 413 sq ft | 38.37 sq m |

G9 dimensions differ as below

| | | |
|------------------|---------------|--------------|
| Reception | 11'9" x 10'6" | 3.58 x 3.20m |
| Kitchen | 9'6" x 6'9" | 2.90 x 2.06m |
| Total | 405 sq ft | 37.63 sq m |



G7



G9

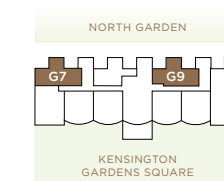

Floor plans shown are for approximate measurements only. Floor plans not to scale. Exact layout and sizes may vary. Furniture sizes and layout are for indicative purposes only.



APARTMENT G8
1 BEDROOM APARTMENT
GROUND FLOOR

| | | |
|--------------------------|---------------|--------------|
| Reception/Kitchen | 12'6" x 11'9" | 3.81 x 3.58m |
| Bedroom | 9'6" x 8'6" | 2.90 x 2.59 |
| Total | 324 sq ft | 30.10 sq m |

APARTMENTS 10 & 18
1 BEDROOM APARTMENT
FIRST FLOOR

| | | |
|------------------|---------------|--------------|
| Reception | 11'9" x 11'9" | 3.58 x 3.58m |
| Kitchen | 9'3" x 6'9" | 2.82 x 2.06m |
| Bedroom | 11'9" x 10'3" | 3.58 x 3.12m |
| Total | 414 sq ft | 38.46 sq m |

10 dimensions differ as below

| | | |
|------------------|---------------|--------------|
| Reception | 11'9" x 10'6" | 3.58 x 3.20m |
| Kitchen | 9'3" x 6'9" | 2.82 x 2.06m |
| Total | 404 sq ft | 37.53 sq m |

APARTMENT 11
2 BEDROOM APARTMENT
FIRST FLOOR

| | | |
|-----------------------|---------------|--------------|
| Reception | 18'6" x 13'3" | 5.64 x 4.04m |
| Kitchen | 9'9" x 8'6" | 2.97 x 2.59m |
| Master Bedroom | 13'6" x 9'9" | 4.11 x 2.97m |
| Bedroom 2 | 11'3" x 9'0" | 3.43 x 2.74 |
| Total | 781 sq ft | 72.56 sq m |

APARTMENTS 12, 13, 14, 15 & 16
1 BEDROOM APARTMENT
FIRST FLOOR

| | | |
|--------------------------|--------------|--------------|
| Reception/Kitchen | 22' x 8'6" | 6.71 x 2.59m |
| Bedroom | 10'3" x 9'6" | 3.12 x 2.90m |
| Total | 390 sq ft | 36.23 sq m |



18



10

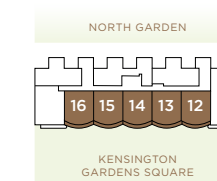
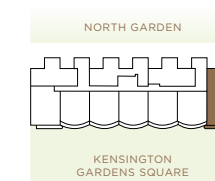
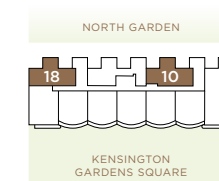
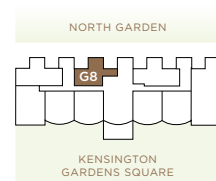

Floor plans shown are for approximate measurements only. Floor plans not to scale. Exact layout and sizes may vary. Furniture sizes and layout are for indicative purposes only.



APARTMENT 17
1 BEDROOM APARTMENT
FIRST FLOOR

Reception/Kitchen
18'6" x 14'0" 5.64 x 4.27m

Bedroom
11'6" x 8'9" 3.51 x 2.67m

Total
464 sq ft 43.11 sq m

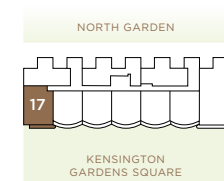

APARTMENT 19
1 BEDROOM APARTMENT
FIRST FLOOR

Reception
11'9" x 11'3" 3.58 x 3.43m

Kitchen
12' x 9'3" 3.66 x 2.82m

Bedroom
10'9" x 9'6" 3.28 x 2.90m

Total
478 sq ft 44.41 sq m

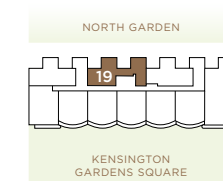

APARTMENTS 20 & 28
1 BEDROOM APARTMENT
SECOND FLOOR

Reception
11'11" x 10'11" 3.6 x 3.3m

Kitchen
9'10" x 7' 3.0 x 2.1m

Bedroom
11'0" x 10'9" 3.4 x 3.3m

Total
410 sq ft 38.09 sq m

20 dimensions differ as below

Reception
11'11" x 11'2" 3.6 x 3.4m

Kitchen
9'6" x 7'3" 2.9 x 2.2m

Bedroom
11'2" x 11'0" 3.4 x 3.4m

Total
408 sq ft 37.90 sq m



28



20

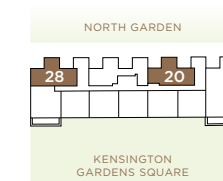

APARTMENT 21
2 BEDROOM APARTMENT
SECOND FLOOR

Reception/Kitchen
18'6" x 17'3" 5.64 x 5.26m

Master Bedroom
13'6" x 9'9" 4.11 x 2.97m

Bedroom 2
11' x 9'0" 3.35 x 2.74m

Total
688 sq ft 63.92 sq m

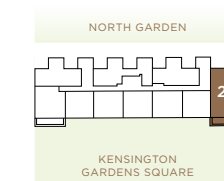

Floor plans shown are for approximate measurements only. Floor plans not to scale. Exact layout and sizes may vary. Furniture sizes and layout are for indicative purposes only.



APARTMENTS 22, 23, 24, 25 & 26

1 BEDROOM APARTMENT
SECOND FLOOR

Reception/Kitchen
17'3" x 10'9" 5.26 x 3.28m

Bedroom
10'0" x 9'3" 3.05 x 2.82m

Total
330 sq ft 30.66 sq m

25 & 26 dimensions differ as below

Total
326 sq ft 30.29 sq m

APARTMENT 27

1 BEDROOM APARTMENT
SECOND FLOOR

Reception/Kitchen
18'6" x 10'3" 5.64 x 3.12m

Bedroom
10'3" x 8'9" 3.12 x 2.67m

Total
371 sq ft 34.47 sq m

APARTMENT 29

1 BEDROOM APARTMENT
SECOND FLOOR

Reception
11'5" x 11'1" 3.50 x 3.40m

Kitchen
12'4" x 9'5" 3.80 x 2.9m

Bedroom
10'9" x 9'9" 3.30 x 3.00m

Total
477 sq ft 44.31 sq m

APARTMENT 31

2 BEDROOM APARTMENT
THIRD FLOOR

Reception/Kitchen
18'6" x 17'6" 5.64 x 5.33m

Master Bedroom
13'6" x 9'9" 4.11 x 2.97m

Bedroom 2
11'0" x 9'0" 3.35 x 2.74m

Total
700 sq ft 65.03 sq m

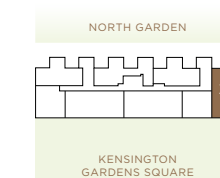
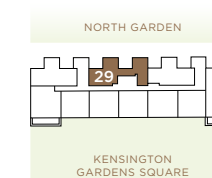
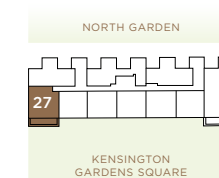
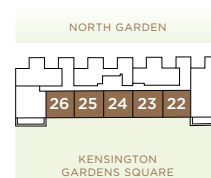

Floor plans shown are for approximate measurements only. Floor plans not to scale. Exact layout and sizes may vary. Furniture sizes and layout are for indicative purposes only.



APARTMENT 32
1 BEDROOM APARTMENT
THIRD FLOOR

| | | |
|--------------------------|--------------|--------------|
| Reception/Kitchen | 17'6" x 9'0" | 5.33 x 2.74m |
| Bedroom | 9'9" x 9'0" | 2.97 x 2.74m |
| Total | 326 sq ft | 30.29 sq m |

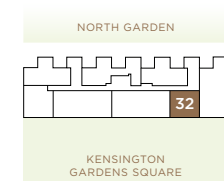

APARTMENTS 33 & 34
2 BEDROOM APARTMENT
THIRD FLOOR

| | | |
|--------------------------|---------------|--------------|
| Reception/Kitchen | 18'6" x 17'9" | 5.64 x 5.41m |
| Master Bedroom | 10'3" x 8'3" | 3.12 x 2.51 |
| Bedroom 2 | 12'0" x 9'9" | 3.66 x 2.97m |
| Total | 690 sq ft | 64.10 sq m |

34 dimensions differ as below

| | | |
|--------------------------|---------------|--------------|
| Reception/Kitchen | 18'6" x 17'3" | 5.64 x 5.26m |
| Master Bedroom | 10'3" x 8'0" | 3.12 x 2.44m |
| Bedroom 2 | 10' x 8'0" | 3.05 x 2.44m |
| Total | 689 sq ft | 64.01 sq m |

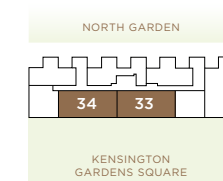

APARTMENT 35
1 BEDROOM APARTMENT
THIRD FLOOR

| | | |
|--------------------------|--------------|--------------|
| Reception/Kitchen | 18'6" x 9'9" | 5.64 x 2.97m |
| Bedroom | 11'0" x 8'9" | 3.35 x 2.67m |
| Total | 376 sq ft | 34.93 sq m |

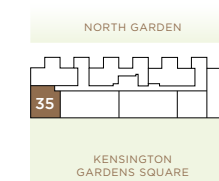

APARTMENTS 36 & 38
1 BEDROOM APARTMENT
THIRD FLOOR

| | | |
|------------------|---------------|--------------|
| Reception | 11'9" x 11'0" | 3.58 x 3.35m |
| Kitchen | 9'3" x 7'0" | 2.82 x 2.13m |
| Bedroom | 11'0" x 11'0" | 3.35 x 3.35m |
| Total | 411 sq ft | 38.18 sq m |

38 dimensions differ as below

| | | |
|------------------|----------------|------------|
| Reception | 11'10" x 9'8" | 3.6 x 3.0m |
| Kitchen | 9'4" x 6'9" | 2.9 x 2.1m |
| Bedroom | 11'2" x 10'11" | 3.4 x 3.3m |
| Total | 406 sq ft | 37.72 sq m |



36



38

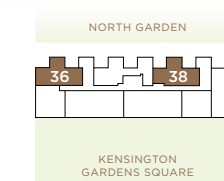

Floor plans shown are for approximate measurements only. Floor plans not to scale. Exact layout and sizes may vary. Furniture sizes and layout are for indicative purposes only.



APARTMENT 37
1 BEDROOM APARTMENT
THIRD FLOOR

| | | |
|------------------|---------------|--------------|
| Reception | 11'3" x 11'0" | 3.43 x 3.35m |
| Kitchen | 9'3" x 7'9" | 2.82 x 2.36m |
| Bedroom | 9'9" x 7'6" | 2.97 x 2.29m |
| Total | 474 sq ft | 44.04 sq m |

APARTMENT 41
2 BEDROOM APARTMENT
FOURTH FLOOR

| | | |
|--------------------------|---------------|--------------|
| Reception/Kitchen | 18'9" x 17'3" | 5.71 x 5.26m |
| Master Bedroom | 9'3" x 8'3" | 2.82 x 2.51m |
| Bedroom 2 | 11'0" x 9'3" | 3.35 x 2.82m |
| Total | 604 sq ft | 56.11 sq m |

APARTMENT 42
1 BEDROOM APARTMENT
FOURTH FLOOR

| | | |
|--------------------------|--------------|--------------|
| Reception/Kitchen | 17'6" x 9'0" | 5.33 x 2.74m |
| Bedroom | 9'9" x 7'6" | 2.97 x 2.29 |
| Total | 344 sq ft | 31.96 sq m |

APARTMENTS 43 & 44
2 BEDROOM APARTMENT
FOURTH FLOOR

| | | |
|--------------------------|---------------|--------------|
| Reception/Kitchen | 19'0" x 17'6" | 5.79 x 5.33m |
| Master Bedroom | 10' x 8'0" | 3.05 x 2.44m |
| Bedroom 2 | 11'0" x 6'6" | 3.35 x 1.98m |
| Total | 698 sq ft | 64.85 sq m |

44 dimensions differ as below

| | | |
|--------------------------|---------------|--------------|
| Reception/Kitchen | 19'6" x 17'6" | 5.94 x 5.33m |
| Master Bedroom | 10'0" x 7'9" | 3.05 x 2.36m |
| Total | 702 sq ft | 65.22 sq m |

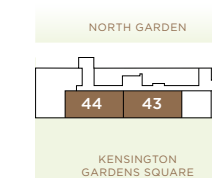
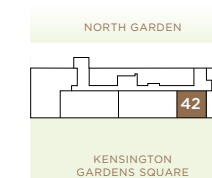
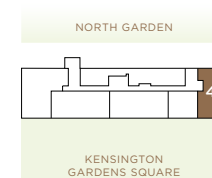
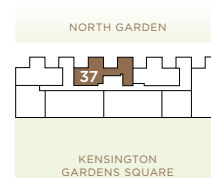

Floor plans shown are for approximate measurements only. Floor plans not to scale. Exact layout and sizes may vary. Furniture sizes and layout are for indicative purposes only.



APARTMENT 46
2 BEDROOM APARTMENT
FOURTH FLOOR

| | | |
|-----------------------|---------------|------------|
| Reception | 12'0" x 11'1" | 3.7 x 3.4m |
| Kitchen | 11'1" x 6'7" | 3.4 x 2m |
| Master Bedroom | 19'1" x 11'2" | 5.8 x 3.4m |
| Bedroom 2 | 11'2" x 10'8" | 3.4 x 3.2 |
| Total | 697 sq ft | 64.75 sq m |



APARTMENT 45
2 BEDROOM APARTMENT
FOURTH FLOOR

| | | |
|-----------------------|---------------|------------|
| Reception | 19'1" x 12'6" | 5.8 x 3.8m |
| Kitchen | 8'11" x 8'2" | 2.7 x 2.5m |
| Master Bedroom | 12'4" x 11'3" | 3.8 x 3.4m |
| Bedroom 2 | 11'3" x 11'0" | 3.4 x 3.4 |
| Total | 783 sq ft | 697 sq m |



APARTMENT 51
1 BEDROOM APARTMENT
FIFTH FLOOR

| | | |
|--------------------------|---------------|------------|
| Reception/Kitchen | 18'2" x 16'2" | 5.5 x 4.9m |
| Bedroom | 10'7" x 9'2" | 3.2 x 2.8m |
| Total | 545 sq ft | 50.63 sq m |

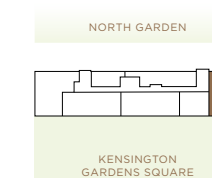
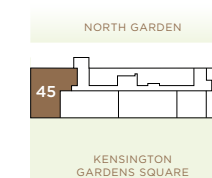
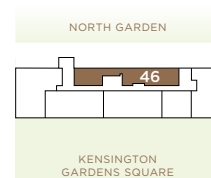

Floor plans shown are for approximate measurements only. Floor plans not to scale. Exact layout and sizes may vary. Furniture sizes and layout are for indicative purposes only.

APARTMENT 52
1 BEDROOM APARTMENT
FIFTH FLOOR

Reception/Kitchen
16'0" x 9'0" 4.88 x 2.74m

Bedroom
10'0" x 8'6" 3.05 x 2.59m

Total
329 sq ft 30.57 sq m



APARTMENTS 53 & 54
2 BEDROOM APARTMENT
FIFTH FLOOR

Reception/Kitchen
19'3" x 16'0" 5.87 x 4.88m

Master Bedroom
8'6" x 8'6" 2.59 x 2.59m

Bedroom 2
10'9" x 8'3" 3.28 x 2.51m

Total
659 sq ft 61.22 sq m

54 dimensions differ as below

Master Bedroom
8'6" x 8'3" 2.59 x 2.51m

Total
662 sq ft 61.50 sq m



APARTMENT 55
2 BEDROOM APARTMENT
FIFTH FLOOR

Reception/Kitchen
18'0" x 14'3" 5.49 x 4.34m

Master Bedroom
11'0" x 9'6" 3.35 x 2.90m

Bedroom 2
11'0" x 9'6" 3.35 x 2.90m

Total
685 sq ft 63.64 sq m



APARTMENT 56
1 BEDROOM APARTMENT
FIFTH FLOOR

Reception/Kitchen
9'6" x 6'6" 2.9 x 1.98m

Bedroom
7'6" x 6'6" 2.29 x 1.98m

Total
200 sq ft 18.58 sq m

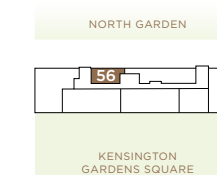
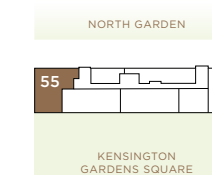
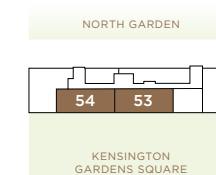
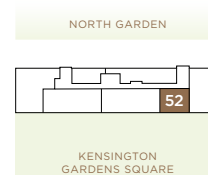

Floor plans shown are for approximate measurements only. Floor plans not to scale. Exact layout and sizes may vary. Furniture sizes and layout are for indicative purposes only.



APARTMENT 57
 1 BEDROOM APARTMENT
 FIFTH FLOOR

| | |
|--------------------------|------------|
| Reception/Kitchen | |
| 18'9" x 9'9" | 5.7 x 3m |
| Bedroom | |
| 10'6" x 9'8" | 3.2 x 2.9m |
| Total | |
| 410 sq ft | 38.09 sq m |



RESIDENTIAL LAND HEADQUARTERS, MAYFAIR

RESIDENTIAL LAND

GARDEN HOUSE IS BROUGHT TO YOU BY RESIDENTIAL LAND, A PRIME CENTRAL LONDON PROPERTY EXPERT WITH A 20-YEAR TRACK RECORD IN DELIVERING HIGH-QUALITY DESIGN, REFURBISHMENT AND DEVELOPMENT.

Based in the heart of Mayfair, Residential Land is one of London's largest private landlords with an exclusive portfolio of over 1,000 properties located in the best areas across London. Residential Land has completed over 850 transactions and are specialists in acquisitions, high-end interior design and construction.

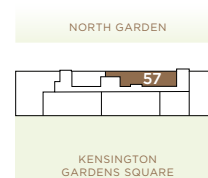

Floor plans shown are for approximate measurements only. Floor plans not to scale. Exact layout and sizes may vary. Furniture sizes and layout are for indicative purposes only.

