

EXPRESS





invest | **URKE** | **24**

ABOUT US

The partners of "Invest - Urke - 24" company combining academic , brand management , architecture and engineering skills within the same body, contributed to real estate sector with their many valuable projects.

"Invest - Urke - 24" benefits from the guidance of both national and international sectoral analyses providing a constant improvement of its vision from Istanbul to the worldwide .

www.investinsaat.com

www.urkeinsaat.com.tr

www.24gayrimenkul.com

**A PROFITABLE INVESTMENT
OPPORTUNITY ON
THE ROAD OF "BASIN EKSPRES"**



EXPRESS24

A UNIQUE CONCEPTED
HOME-OFFICE PROJECT
ON BASIN EKSPRES STREET

Invest - Urke - 24 whose investors have always gained,
now offers a new profitable investment opportunity
by the newest project of Basin Ekspres.



ARCHITECTURAL CONCEPT



THREE FACADED DYNAMIC ARCHITECTURAL FORM





LUXURY,
HAS BEEN HANDLED AS
**AN EXPERIENCE THAT
ENRICHES
THE DAILY LIFE.**

By **Express 24** the service and
the experience both give a project
its real value have been recomposed.





LOFT APARTMENTS
WITH TERRACES



THREE FACADED
ARCHITECTURAL STRUCTURE



SPACIOUS
LIVING AREAS



A MIXTURE OF STORES
THAT HAVE **FACADE DIRECTLY**
TO BASIN EKSPRES ROAD

LIFE



CREATIVE AND COMMUNODIOUS LIVES

**Different Flat Options With "Special to Customer"
Designed Squaremeters**

Express 24 project is the combination of different flat styles. Living areas of every single flat has been considered for providing the needed space with various dimensions to create functional living ambiance.





FOR THOSE WHO LIKE TO
WORK IN THE HOME
OR
**TO EXPERIENCE HOME
COMFORT IN THE OFFICE...**

LOBBY and RECEPTION

An enthusiastic environment has been provided by the means of reception services that are reachable for all of office workers at any time.



MEETING ROOM

In **Express 24** project , a modern meeting room has been composed with a working ambiance satisfying all professional needs gives you the comfort of hosting your guests.

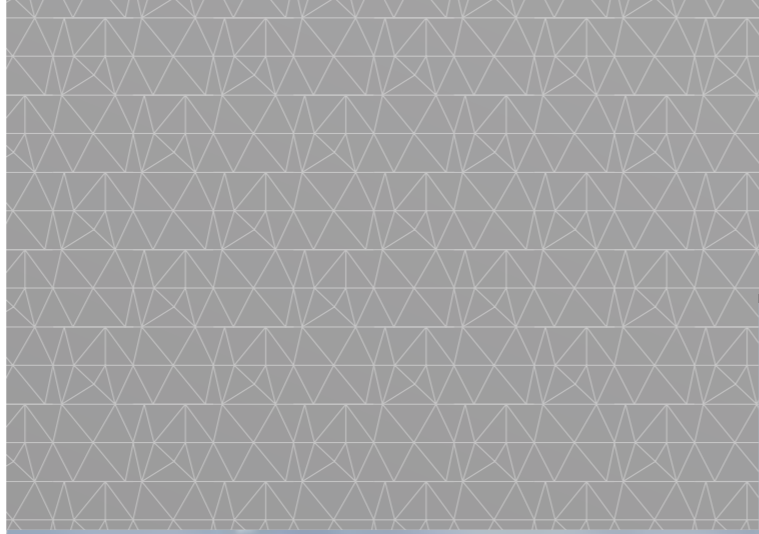

FEEL THE DAYLIGHT

High windows enable the daylight to penetrate into the living rooms envisioned to provide comfortable and luminous environment.





GARAGE and **OPEN PARKING AREAS**

Car parking convenience both in the garage
and outer car park for your guests.
Parking area for every single flat.

BE READY FOR GETTING FIT

Make an energetic start to your day.

The dynamic life in **Express 24** has been perfected with a gym,
equipped with all modern sport devices .



LOCATION



HIGH BRAND EQUITY OF BASIN EKSPRES

Basin Ekspres region outshines in real estate sector as one of the most profitable investment areas in Istanbul.

Basin Ekspres is among the districts that offer a gainful investment choice.



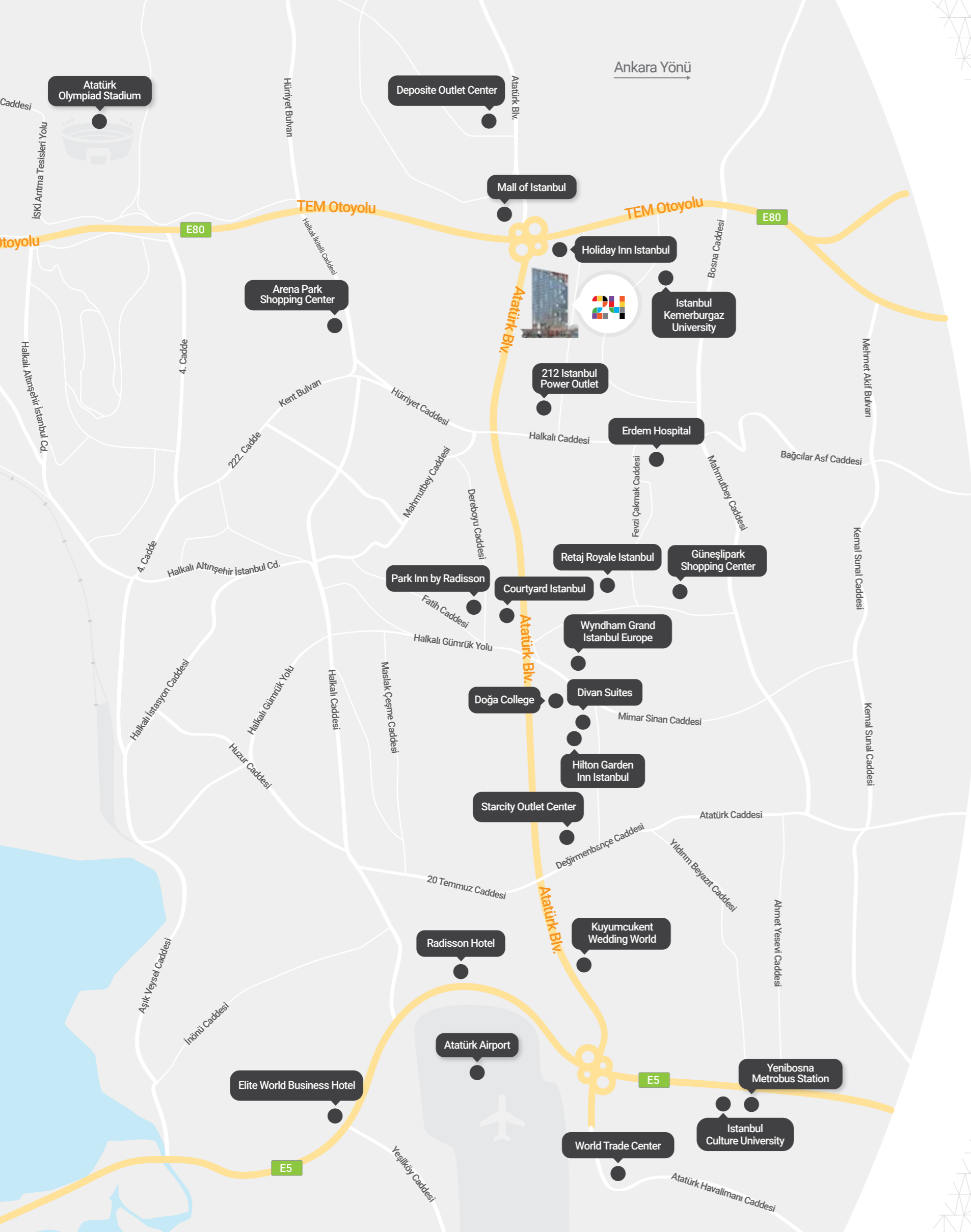

THE NEAREST PLACES TO YOU

TEM and E-5 main road conjunctions, public transport stations, airport, education & health services, shopping & activity centers and so many other places you may need are very near to you.

Find the locations of shopping and living areas, schools, hospitals, stations etc. around the project Express 24.

- Starcity Outlet Center
- Kuyumcukent Wedding World
- Radisson Hotel
- Park Inn by Radisson
- Retaj Royale Istanbul
- Deposit Outlet Center
- Elite World Business Hotel
- Doğa College
- Mall of Istanbul
- Atatürk Airport
- Istanbul Kemerburgaz University
- Holiday Inn Istanbul
- 212 Istanbul Power Outlet
- Wyndham Grand Istanbul Europe
- Güneşlipark Shopping Center
- Courtyard Istanbul
- Divan Suites
- Hilton Garden Inn Istanbul
- Istanbul Culture University
- Yenibosna Metrobus Station
- Atatürk Olympiad Stadium
- World Trade Center
- Arena Park Shopping Center
- Erdem Hospital

STOREY PLANS





FUNCTIONAL AND **LUMINOUS SPACES**

Reserve your functionally designed in every
squaremeter flat now!

Different types of flats are combined with
useful inner layouts and balconies intensifying
the feel of comfort.

2+1 Home Office 108,27m²



2+1	Net m ²
1. Open Office	27,79 m ²
2. Manager Room	12,38 m ²
3. Winter Garden	8,06 m ²
4. WC + Bathroom	4,69 m ²
5. Corridor	2,96 m ²
6. Balcony	14,39 m ²
Net m ² of Flat	70,27 m ²
Overall Gross m²	108,27 m²

2+1 Home 97,27m²

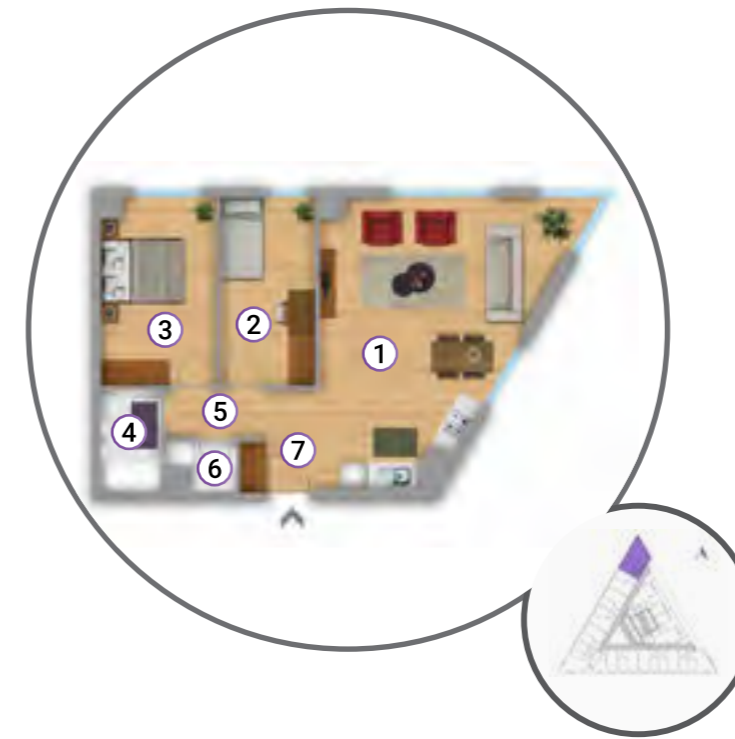

2+1	Net m ²
1. Living room + Kitchen	30,54 m ²
2. Bed room	9,68 m ²
3. Parent Bed Room	11,63 m ²
4. WC + Bathroom	3,48 m ²
5. Corridor	2,53 m ²
6. Laundry Room	1,56 m ²
7. Entrance	3,71 m ²
Net m ² of Flat	63,13 m ²
Overall Gross m²	97,27 m²

1+1 Home Office 66,90m²



1+1	Net m ²
1. Open Office	23,87 m ²
2. Manager Room	11,63 m ²
3. Entrance	4,08 m ²
4. WC + Bathroom	3,84 m ²
Net m ² of Flat	43,42 m ²
Overall Gross m²	66,90 m²

1+1 Home 62,45m²



1+1	Net m ²
1. Living room + Kitchen	20,97 m ²
2. Parent Bed Room	11,79 m ²
3. WC + Bathroom	3,69 m ²
4. Entrance	4,08 m ²
Net m ² of Flat	40,53 m ²
Overall Gross m²	62,45 m²

2+1 Home 202,85m²

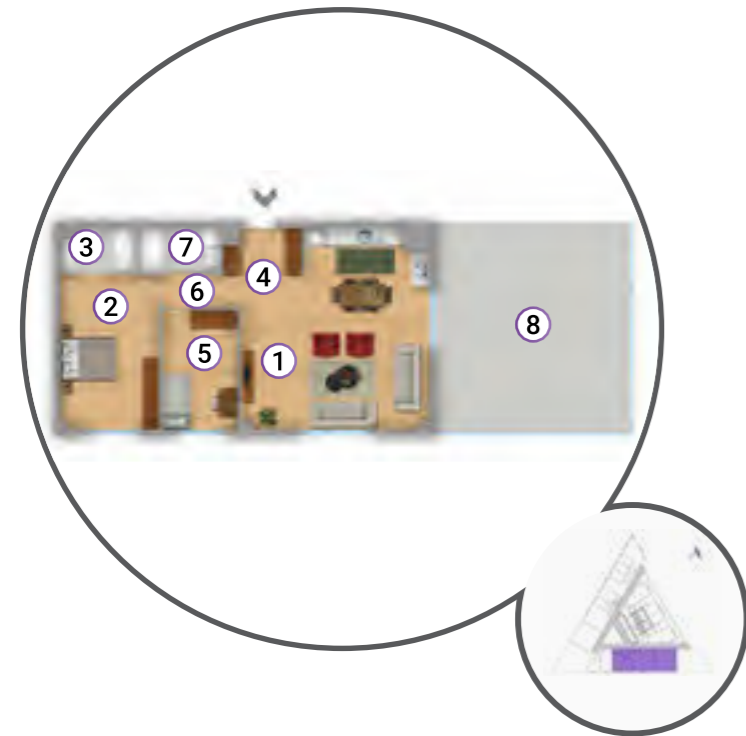

2+1	Net m ²
1 Living room + Kitchen	40,40 m ²
2 Parent Bed Room	17,93 m ²
3 WC + Bathroom	3,75 m ²
4 Entrance	3,96 m ²
5 Bed room	10,66 m ²
6 Corridor	3,18 m ²
7 WC + Bathroom	4,20 m ²
8 Terrace	47,57 m ²
Net m ² of Flat	131,65 m ²
Overall Gross m²	202,85 m²

2+1 Home Office 203,00m²

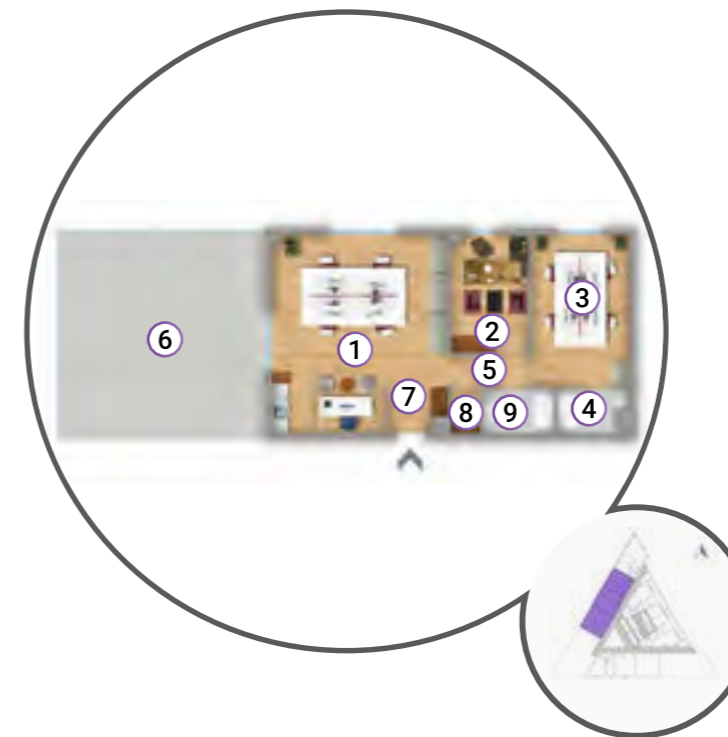

2+1	Net m ²
1 Open Office	37,08 m ²
2 Manager Room	10,95 m ²
3 Office	18,00 m ²
4 WC + Bathroom	3,27 m ²
5 Corridor	3,08 m ²
6 Terrace	51,12 m ²
7 Entrance	3,00 m ²
8 Archive	1,50 m ²
9 WC + Bathroom	3,75 m ²
Net m ² of Flat	131,75 m ²
Overall Gross m²	203,00 m²

